

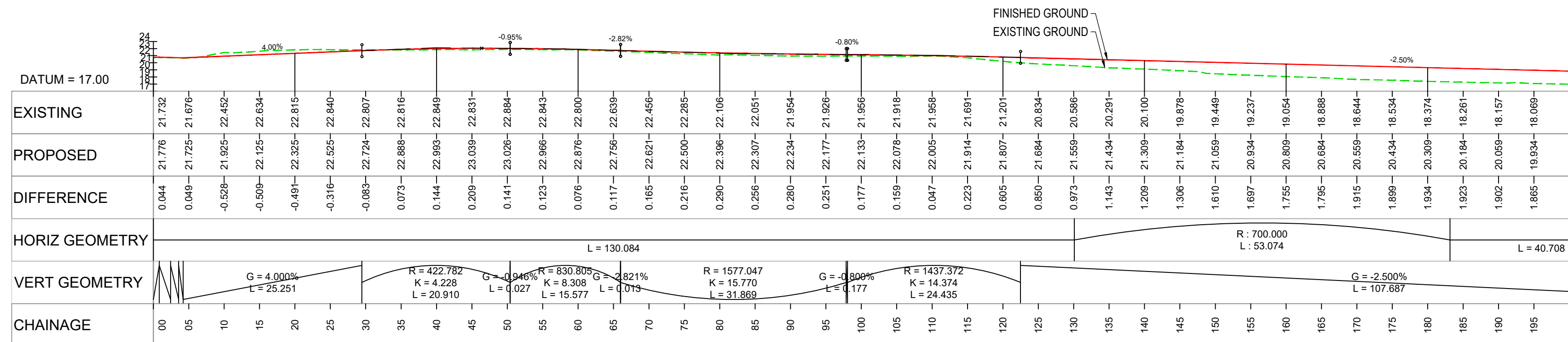

Tionscaldal Éireann
Project Ireland
2040



INTERNAL ACCESS ROAD LONGSECTION
CHAINAGES 0-200m
SCALE: H 1:500 V 1:500

NOTES

- * REFER TO DWG 20_008L-CSE-GEN-XX-DR-C-2210 FOR ROAD CHAINAGE CENTRELINES.

| Rev | Description | Drawn | Checked | Date |
|-----|---------------------|-------|---------|----------|
| P01 | ISSUED FOR PLANNING | SM | IR | 25/10/24 |

Clifton Scannell Emerson Associates Limited
Consulting Engineers,
3rd Floor The Highline,
Bakers Point, Pottery Road,
Dun Laoghaire, Co. Dublin,
Ireland, A96 KW29
T. +353 1 288 5006
F. +353 1 283 3406
E. info@csea.ie
W. www.csea.ie

Client: WICKLOW COUNTY COUNCIL
Project: ASHFORD PARK AND RIDE FACILITY
Dwg. Title: PROPOSED LONGSECTION
Drawn By: SM Date: OCT 2024
Checked By: IR Scale: AS INDICATED @ A1
Project Code: 20_008L - CSE - GEN - XX - DR - C - 2211
Status Code: S02 Part VIII APPROVAL
Revision: P01 FOR PLANNING